

3-Step Model shown with optional
Side and Back Rails



Visit the Tourmaster Choral Risers
web page at www.wengercorp.com for detailed instructions and videos.

CONTENTS

Parts List	2
Fasteners	2
Side Rail Assembly	3
Assemble Slide Leg To Side Rail Leg	3
Assemble Side Rail Legs For All Risers With a 4th Step Addition	6
Assemble Side Rail Legs For All Risers Without a 4th Step Addition	7
Assemble The Side Rail Brackets To the Side Rails	8
Assemble The Swing Brackets To The Side Rails	9
To Attach Side Rails To The Riser	10

- Note:** Side Rails will fit on both the 3-step and 4-step Tourmaster Choral Risers.
- Note:** Please read and understand the Tourmaster Side Rail Assembly Instruction before assembling the Side Rails parts.
- Note:** Remove all items from the shipping carton and arrange them in their approximate final position. Refer to the illustrations on the following pages. If you need additional information, contact the Wenger Corporation using the information below.

PARTS LIST

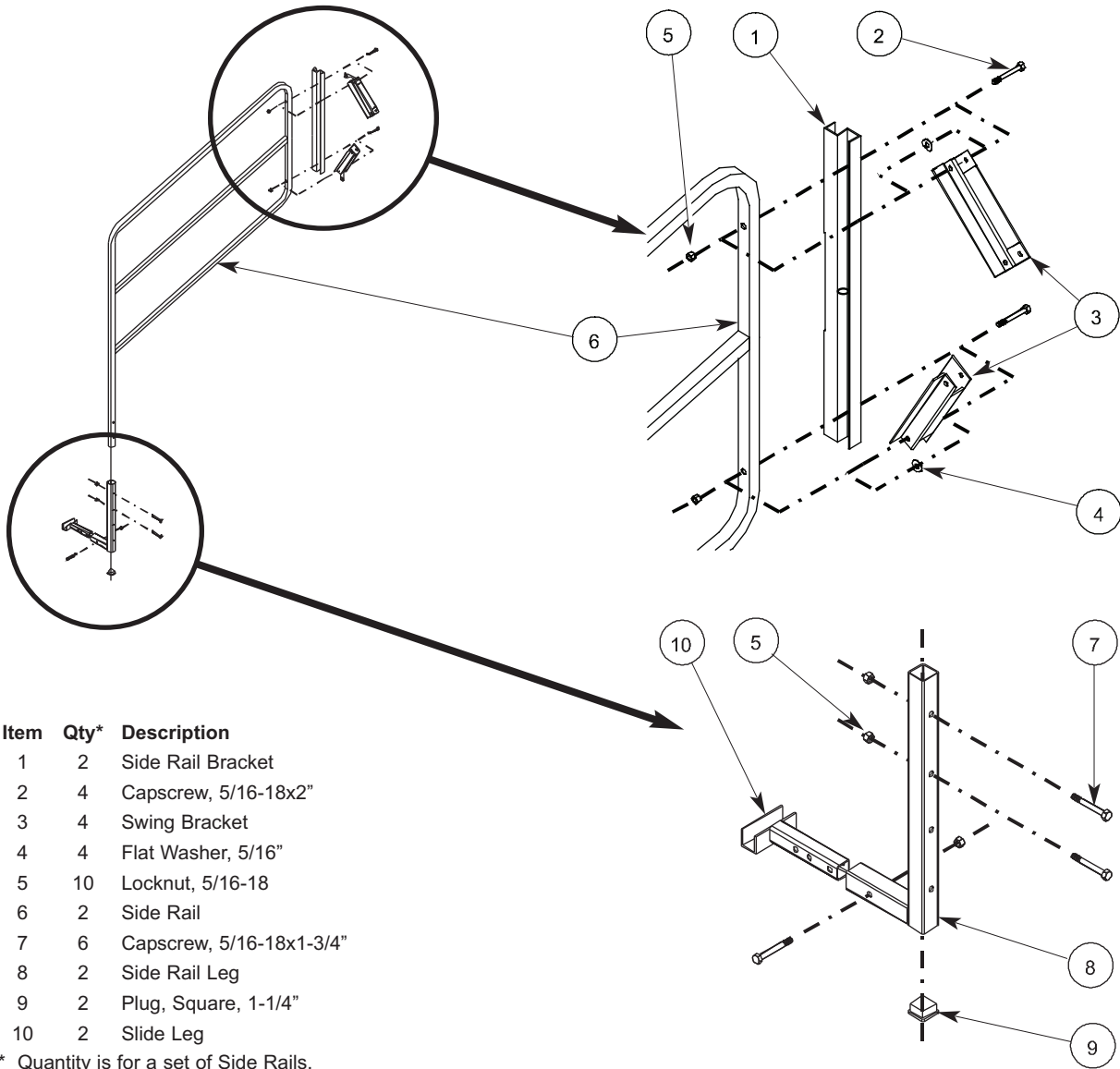

Item	Qty*	Description
1	2	Side Rail Bracket
2	4	Capscrew, 5/16-18x2"
3	4	Swing Bracket
4	4	Flat Washer, 5/16"
5	10	Locknut, 5/16-18
6	2	Side Rail
7	6	Capscrew, 5/16-18x1-3/4"
8	2	Side Rail Leg
9	2	Plug, Square, 1-1/4"
10	2	Slide Leg

* Quantity is for a set of Side Rails.

FASTENERS

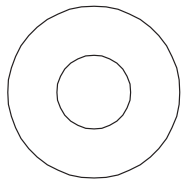

(4) Flat Washer, 5/16"

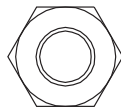

(5) Locknut, 5/16-18

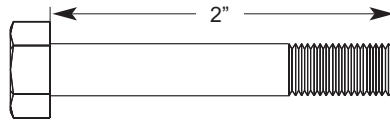

(2) Capscrew, 5/16-18x2"

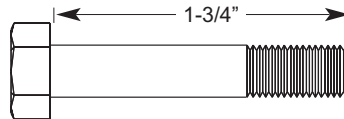

(7) Capscrew, 5/16-18x1-3/4"

SIDE RAIL ASSEMBLY

ASSEMBLE SLIDE LEG TO SIDE RAIL LEG

Note: The position of the (10) Slide Leg depends upon the Tourmaster Riser model. One of three clearance holes in each Slide Leg is used to fasten the Slide Leg to the (8) Side Rail Leg with a single (7) Capscrew, 5/16-18x1-3/4 inches long. The Tourmaster Riser model determines which hole to use. To avoid alignment problems with the Riser, select the correct application from the three methods shown in Step 1, below and on the following page.

1. Insert the (10) Slide Leg into the (8) Side Rail Leg and align the appropriate Clearance Hole of the (10) Slide Leg to the clearance hole in the (8) Side Rail Leg as shown below and on the next page.

Use the Right Hole for the following models:

- For 3-step Tourmaster Risers with 24-inch deep steps
- For 3-step Tourmaster Risers with 24-inch deep steps and the 4th step addition installed

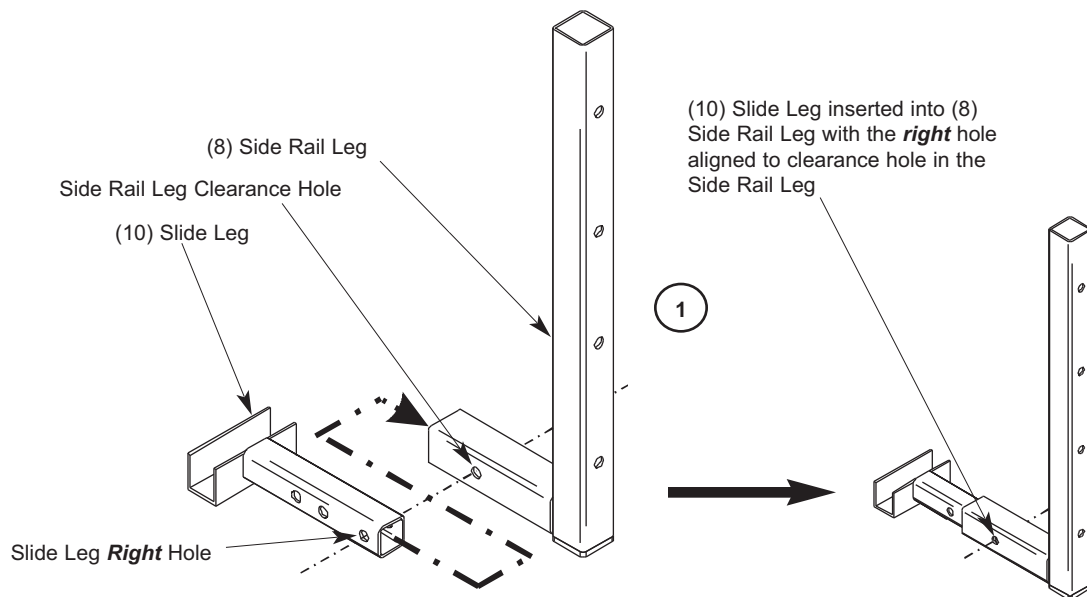

SIDE RAIL ASSEMBLY (CONTINUED)

ASSEMBLE SLIDE LEG TO SIDE RAIL LEG (CONTINUED)

Use the Center Hole for the following models:

- For 6-foot wide 3-step Tourmaster Risers with 18-inch deep steps
- For 6-foot wide Tourmaster Risers with 18-inch deep steps and the 4th step addition installed
- For 4-foot wide 3-step Tourmaster Risers with 18-inch deep steps and the 4th step addition installed

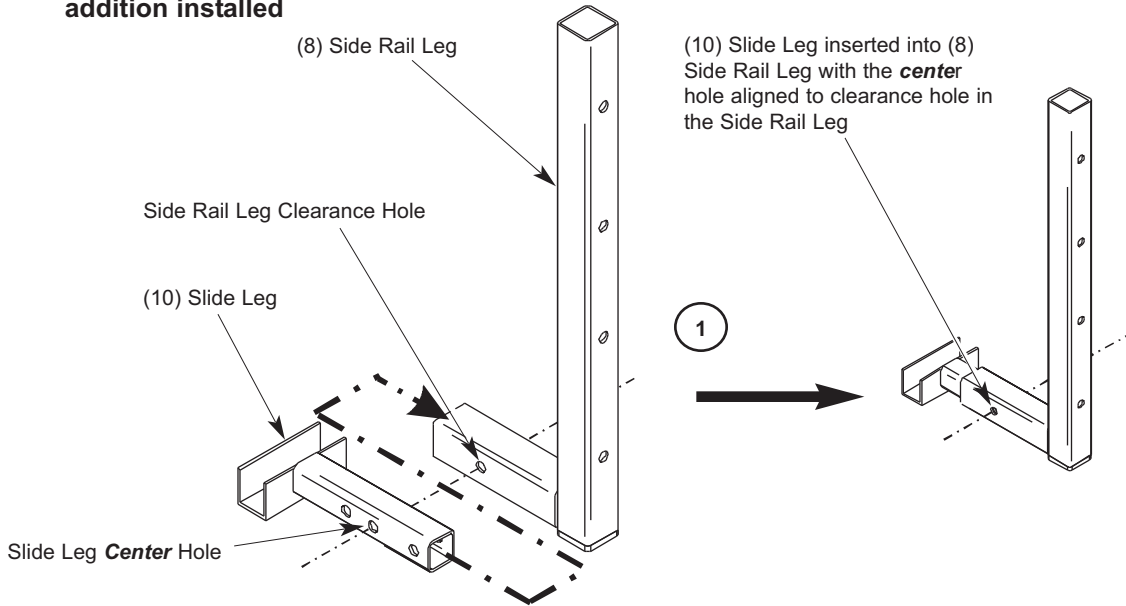

Use the Left Hole for the following models:

- For 4-foot wide 3-step Tourmaster Risers with 18-inch deep steps

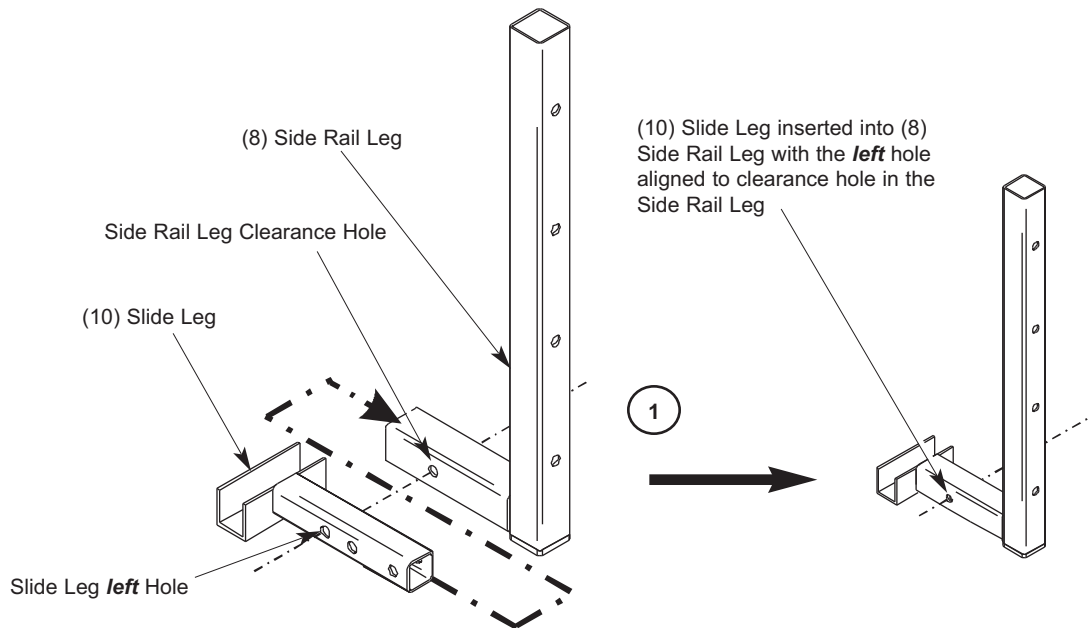

SIDE RAIL ASSEMBLY (CONTINUED)

ASSEMBLE SLIDE LEG TO SIDE RAIL LEG (CONTINUED)

2. Insert a (7) Capscrew, 5/16-18x1-3/4 inch long into the (8) Side Rail Clearance Hole.
3. Using two one-half inch open end wrenches, tighten a (5) Locknut, 5/16-18, on the Capscrew.

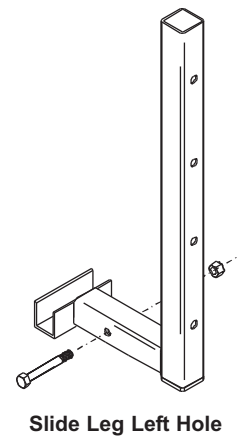
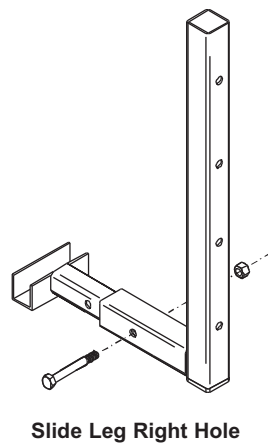
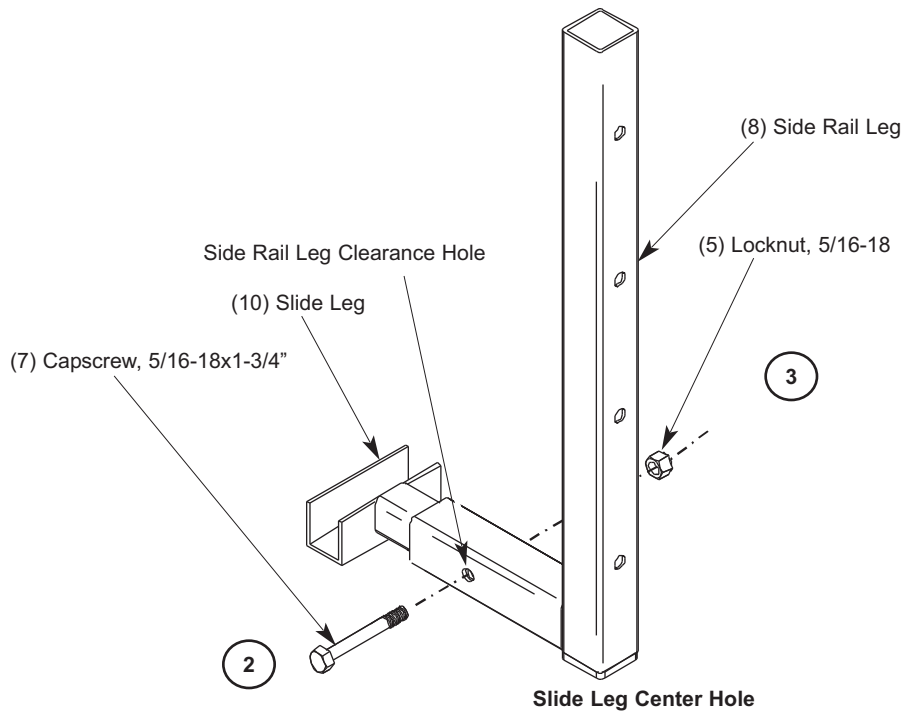

SIDE RAIL ASSEMBLY (CONTINUED)

ASSEMBLE SIDE RAIL LEGS FOR ALL RISERS WITH A 4TH STEP ADDITION

To assemble the (8) Side Rail Leg to a (6) Side Rail for all Risers **with** the 4th Step Addition, do as follows.

1. Slide the (8) Side Rail Leg onto (6) Side Rail with the (10) Slide Leg oriented to the left side.
2. Align the upper holes of the (8) Side Rail Leg with the two clearance holes in the (6) Side Rail.
3. Insert two (7) Capscrews, 5/16-18x1-3/4 inches long, through the two (8) Side Rail Leg Upper Holes.
4. Using two one-half inch open end wrenches, fasten a (5) Locknut, 5/16-18, to each Capscrew and tighten.
5. Repeat Steps 1 through 4, orienting the Slide Leg to the right side.

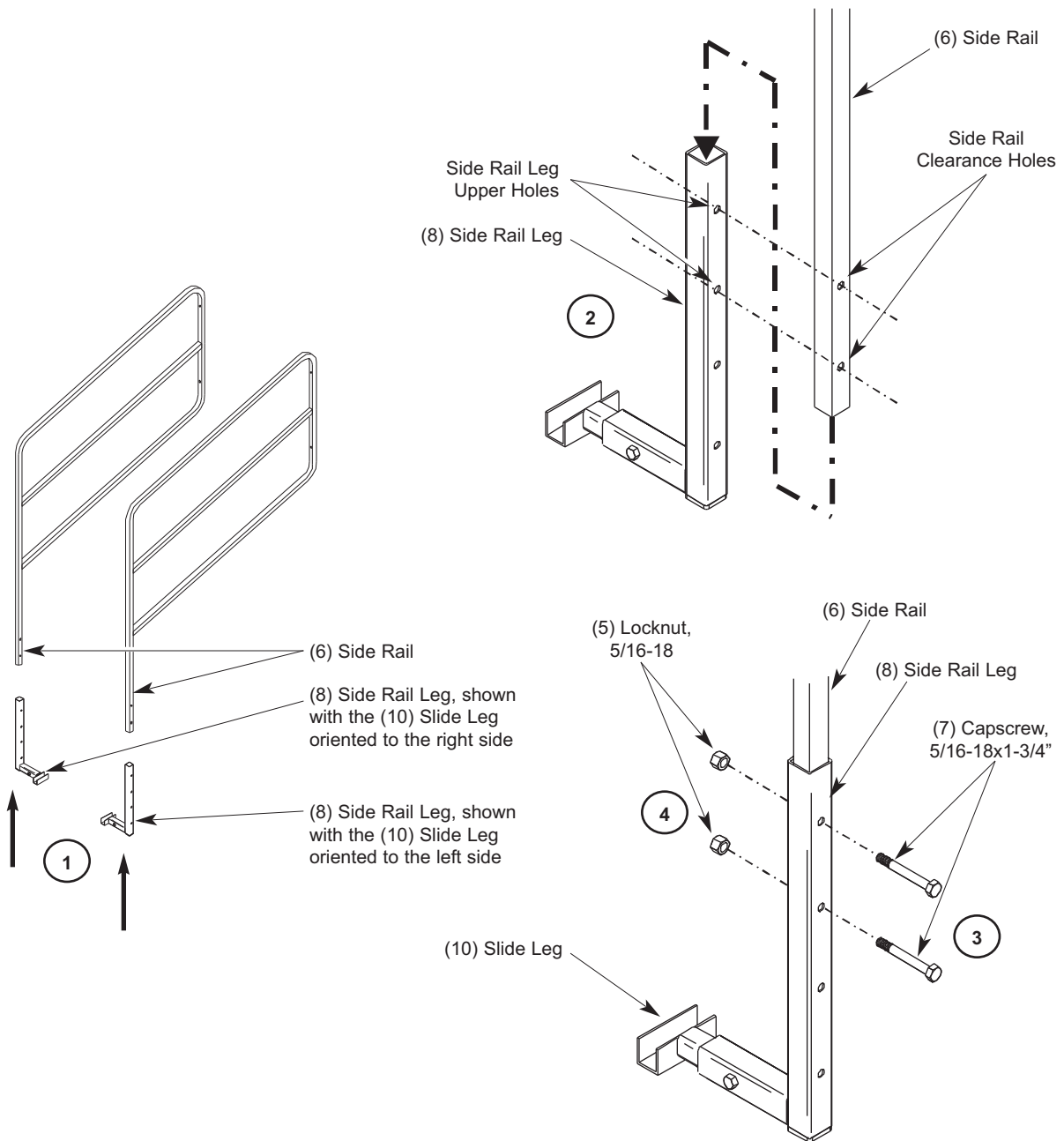

SIDE RAIL ASSEMBLY (CONTINUED)

ASSEMBLE SIDE RAIL LEGS FOR ALL RISERS WITHOUT A 4TH STEP ADDITION

To assemble the (8) Side Rail Leg to a (6) Side Rail for all Risers *without* the 4th Step Addition, do as follows.

1. Slide the (8) Side Rail Leg onto (6) Side Rail with the (10) Slide Leg oriented to the left side.
2. Align the lower holes of the (8) Side Rail Leg with the two clearance holes in the (6) Side Rail.
3. Insert two (7) Capscrews, 5/16-18x1-3/4 inches long, through the two (8) Side Rail Leg Lower Holes.
4. Using two one-half inch open end wrenches, fasten a (5) Locknut, 5/16-18, to each Capscrew and tighten.
5. Repeat Steps 1 through 4, orienting the Slide Leg to the right side.

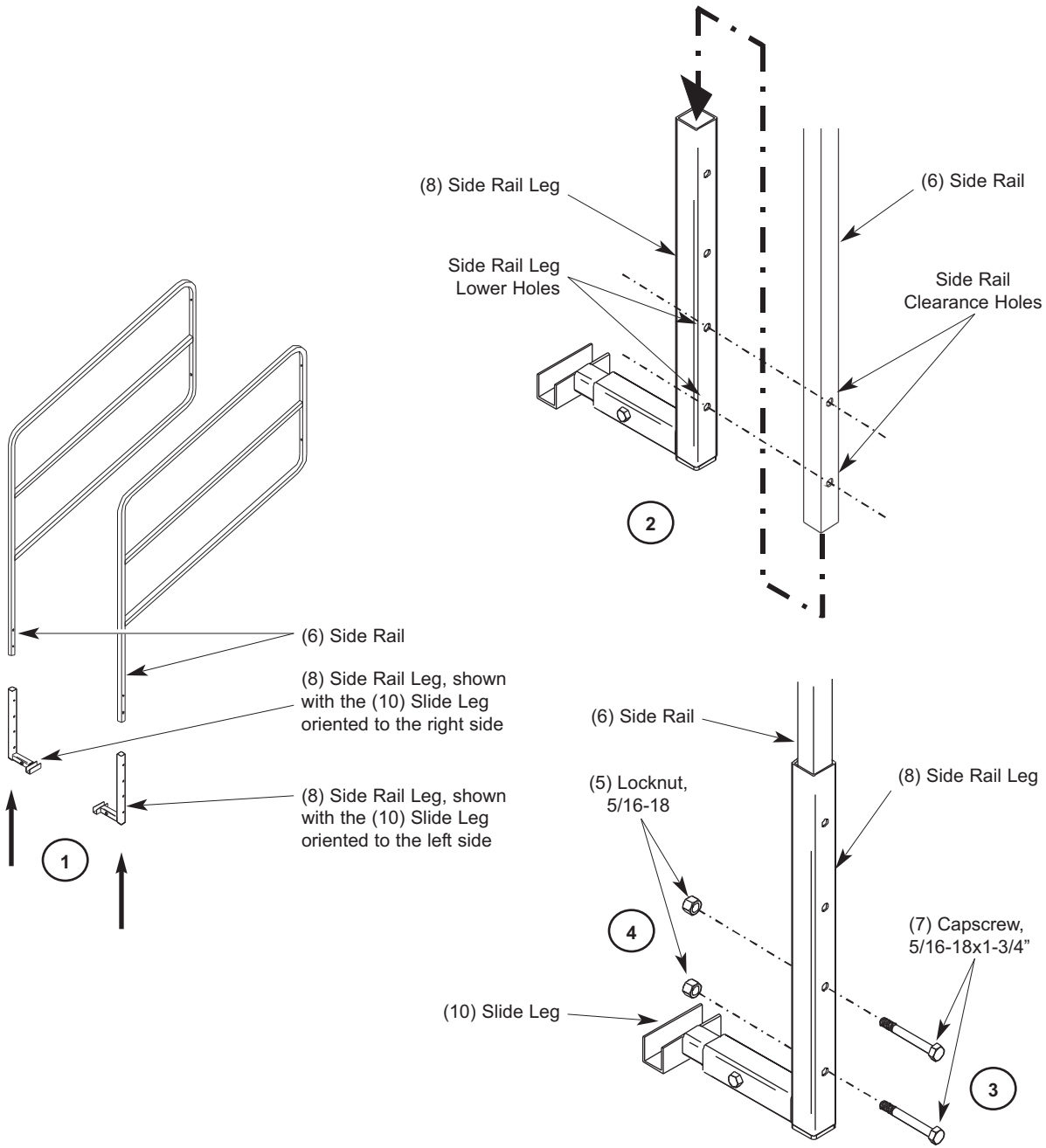

SIDE RAIL ASSEMBLY (CONTINUED)

ASSEMBLE THE SIDE RAIL BRACKETS TO THE SIDE RAILS

1. Place the (1) Side Rail Bracket onto each (6) Side Rail as shown in the illustration below. Align the clearance holes in each bracket to the clearance holes in each (6) Side Rail.

Note: Make sure that the S shape or open channel of the (1) Side Rail Bracket is on the same side as the (10) Slide Leg.

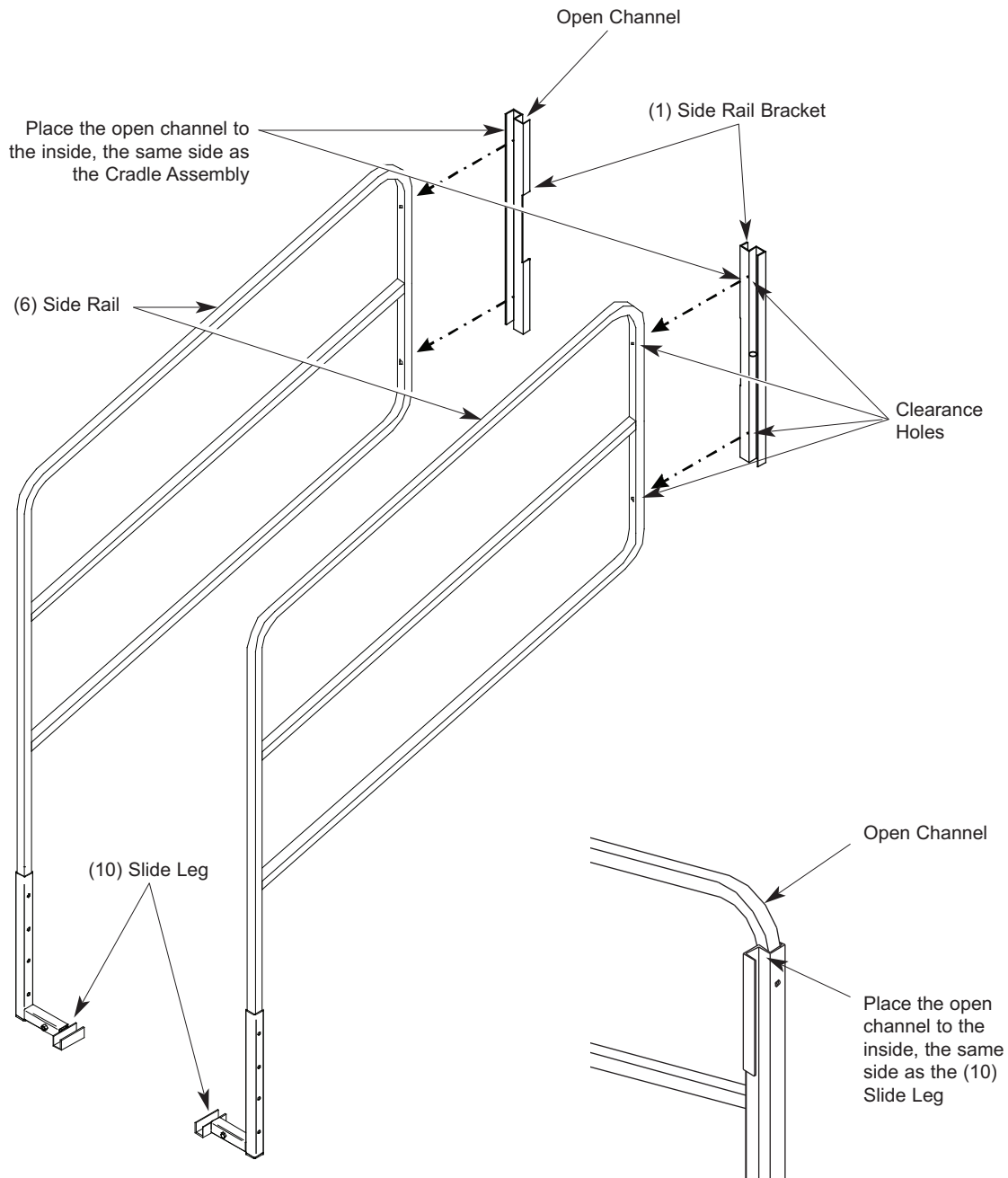

SIDE RAIL ASSEMBLY (CONTINUED)

ASSEMBLE THE SWING BRACKETS TO THE SIDE RAILS

1. Position two (3) Swing Brackets on a (6) Side Rail on the side away from the (1) Side Rail Bracket open channel with two (4) Flat Washers inserted between the Swing Bracket and Side Rail Bracket, as shown in the illustration below.

Note: Make sure that the (4) Flat Washer is between the (1) Side Rail Bracket and (3) Swing Bracket as shown below.

2. Fasten the Swing Brackets with two (2) Capscrews, 5/16-18x2", and two (5) Locknuts, 5/16-18.
3. Using two one-half inch open end wrenches, tighten the Locknuts until the Bracket cannot rotate.
4. Then loosen the Locknut until the Bracket can be easily rotated by hand but will remain in position without the weight of the Bracket causing it to rotate.
5. Repeat steps 1 to 4 on the other Side Rail.

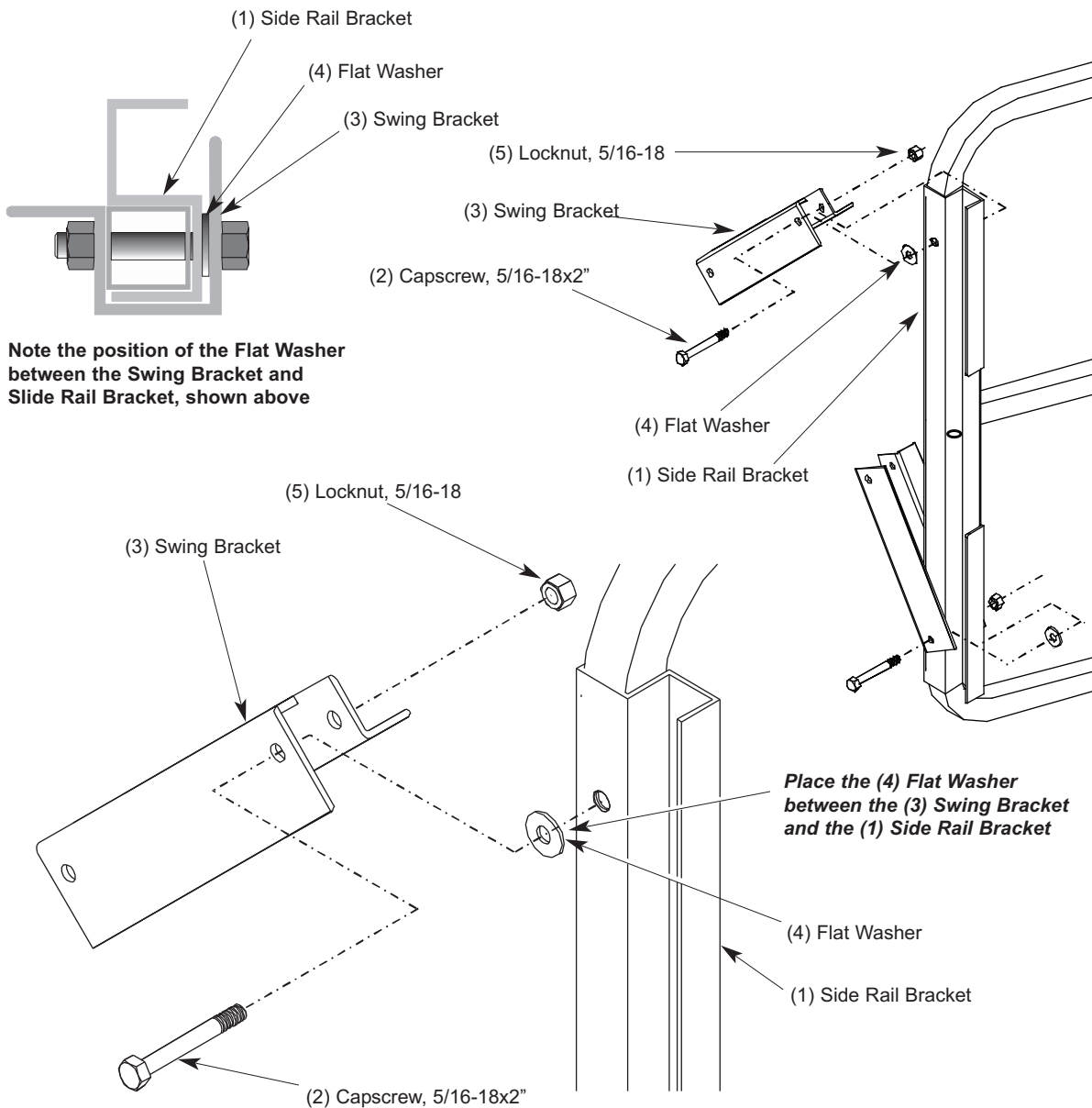

TO ATTACH SIDE RAILS TO THE RISER

Note: Back Rails are required in order to attach Side Rails.

1. Place the Side Rail in the approximate attachment position with the leg extension resting on the floor. Slide the Side Rail towards the Back Rail until the Side Rail Bracket fits over the Back Rail as shown below.

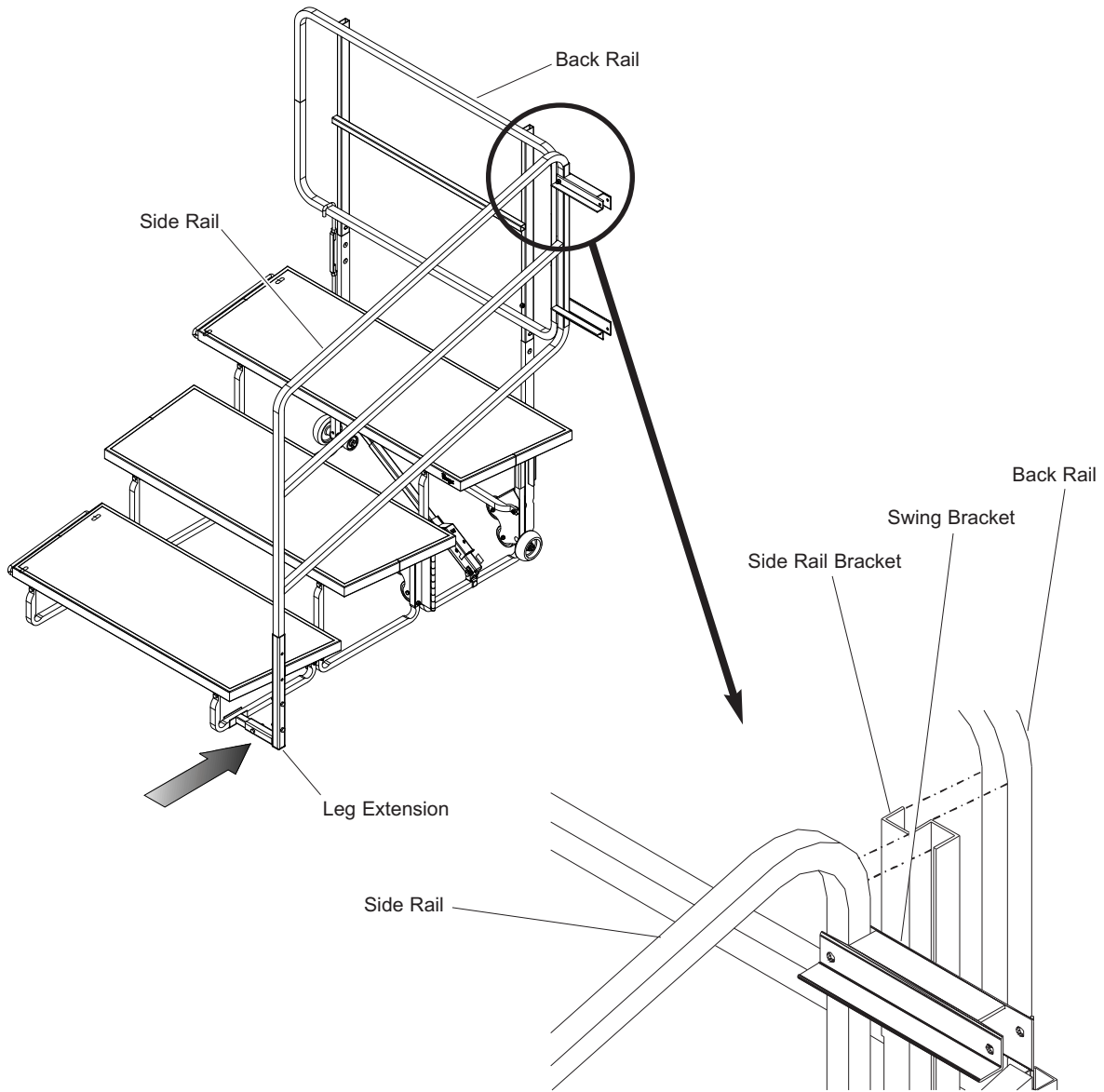

TO ATTACH SIDE RAILS TO THE RISER (CONTINUED)

2. Rotate the Upper and Lower Swing Brackets to a vertical position, locking the Side Rail to the Back Rail.

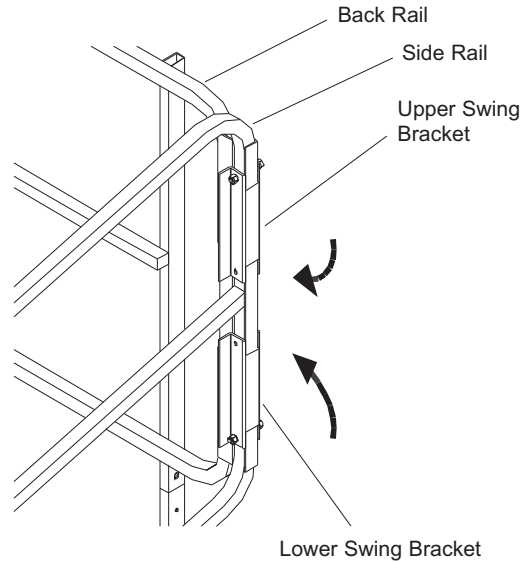

3. Lift and hold the front of the riser off the floor and slide the Lower Leg Cradle Bracket under the Step Support Frame. Lower the Front Riser placing the Step Support Frame into the Lower Leg Cradle Bracket.

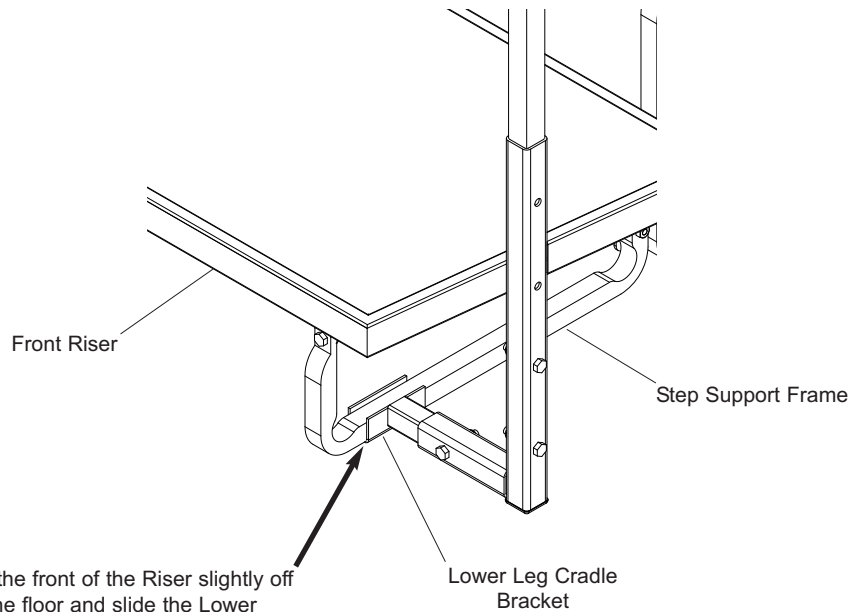

Lift the front of the Riser slightly off of the floor and slide the Lower Leg Cradle Bracket under the Step Support Frame. Lower the Frame into the Cradle.

TO ATTACH SIDE RAILS TO THE RISER (CONTINUED)

4. A Rail Lock Down Bracket is used to reduce movement of the Back Rail when using the Side Rail. Thread the Right and Left Hooks into the Turnbuckle. Engage the Back Rail and Top Step with the Rail Lock Down Bracket Hooks as shown below. Tighten the Rail Lock Down Bracket by turning the Turnbuckle clockwise.

